

Stainless Steel Enviroline® Series Free-Standing Two-Door Enclosures

Application -

Designed to house a variety of electrical and electronic controls and instruments. Provisions for optional surface mounting or rack mounting of almost any type of equipment. Provides protection from dust, dirt, water and oil. The enclosures are extra deep for applications requiring more interior space.

Construction -

- 0.104" Stainless Steel Type 304 & 316/316L.
- Removable and interchangeable doors.
- Concealed hinge.
- Seams continuously welded and ground smooth.
- Strong, rigid construction with stiffeners welded on backs of single access boxes.
- Lifting eyes for easy handling.
- Black zinc die cast keylocking/padlocking handle.
- 3-point latching mechanism.
- Black quarter turn latches as required.
- Latch rods have rollers for easier door closing.
- Flange trough collar around all sides of door opening.
- Removable center post.
- Removable print pocket.
- Mounting channels welded horizontally on sides of interior body at top, bottom and middle for mounting optional panels or rack mounting angles.
- Oil resistant gasket.
- Ground stud on door.
- Provisions for light kit.

Finish -

#4 brushed finish on all exterior surfaces. Optional panels are powder coated white.

Accessories - See pages 116-123

IS5 - Industry Standards -

NEMA Type 4, 4X, 12 & Type 13
UL Listed Type 4, 4X & 12
CSA Type 4, 4X & 12
IEC 60529 IP66

304 STAINLESS STEEL ENVIROLINE® SERIES FREE-STANDING TWO-DOOR ENCLOSURES

ENCLOSURE PRODUCT CODE S4					
Catalog No.	Height (A)	Width (B)	Depth (C)	Industry Standard	List Price
SCE-60EL4818SSFSD	60.00	48.00	18.00	IS5	8,019.42
SCE-72EL4818SSFSD	72.00	48.00	18.00	IS5	8,840.69
SCE-72EL4824SSFSD	72.00	48.00	24.00	IS5	9,521.55
SCE-72EL6018SSFSD	72.00	60.00	18.00	IS5	9,861.99
SCE-72EL6024SSFSD	72.00	60.00	24.00	IS5	10,615.02
SCE-72EL6036SSFSD	72.00	60.00	36.00	IS5	12,110.83
SCE-72EL7218SSFSD	72.00	72.00	18.00	IS5	10,906.00
SCE-72EL7224SSFSD	72.00	72.00	24.00	IS5	11,731.26
SCE-90EL4820SSFSD	90.00	48.00	20.00	IS5	10,321.52
SCE-90EL7220SSFSD	90.00	72.00	20.00	IS5	12,820.70
SCE-90EL7224SSFSD	90.00	72.00	24.00	IS5	13,429.38
SCE-90EL7236SSFSD	90.00	72.00	36.00	IS5	15,275.91

316 STAINLESS STEEL ENVIROLINE® SERIES FREE-STANDING TWO-DOOR ENCLOSURES

ENCLOSURE PRODUCT CODE S7					
Catalog No.	Height (A)	Width (B)	Depth (C)	Industry Standard	List Price
SCE-60EL4818SS6FSD	60.00	48.00	18.00	IS5	9,623.31
SCE-72EL4818SS6FSD	72.00	48.00	18.00	IS5	10,608.83
SCE-72EL4824SS6FSD	72.00	48.00	24.00	IS5	11,425.87
SCE-72EL6018SS6FSD	72.00	60.00	18.00	IS5	11,834.39
SCE-72EL6024SS6FSD	72.00	60.00	24.00	IS5	12,738.03
SCE-72EL6036SS6FSD	72.00	60.00	36.00	IS5	14,533.00
SCE-72EL7218SS6FSD	72.00	72.00	18.00	IS5	13,087.20
SCE-72EL7224SS6FSD	72.00	72.00	24.00	IS5	14,077.51
SCE-90EL4820SS6FSD	90.00	48.00	20.00	IS5	12,385.82
SCE-90EL7220SS6FSD	90.00	72.00	20.00	IS5	15,384.84
SCE-90EL7224SS6FSD	90.00	72.00	24.00	IS5	16,115.26
SCE-90EL7236SS6FSD	90.00	72.00	36.00	IS5	18,331.10



Available within 10 working days if not in stock

Phone (989) 799-6871
Fax (989) 799-4524



STAINLESS STEEL ENVIROLINE® SERIES FREE-STANDING TWO-DOOR ENCLOSURES TECHNICAL DATA

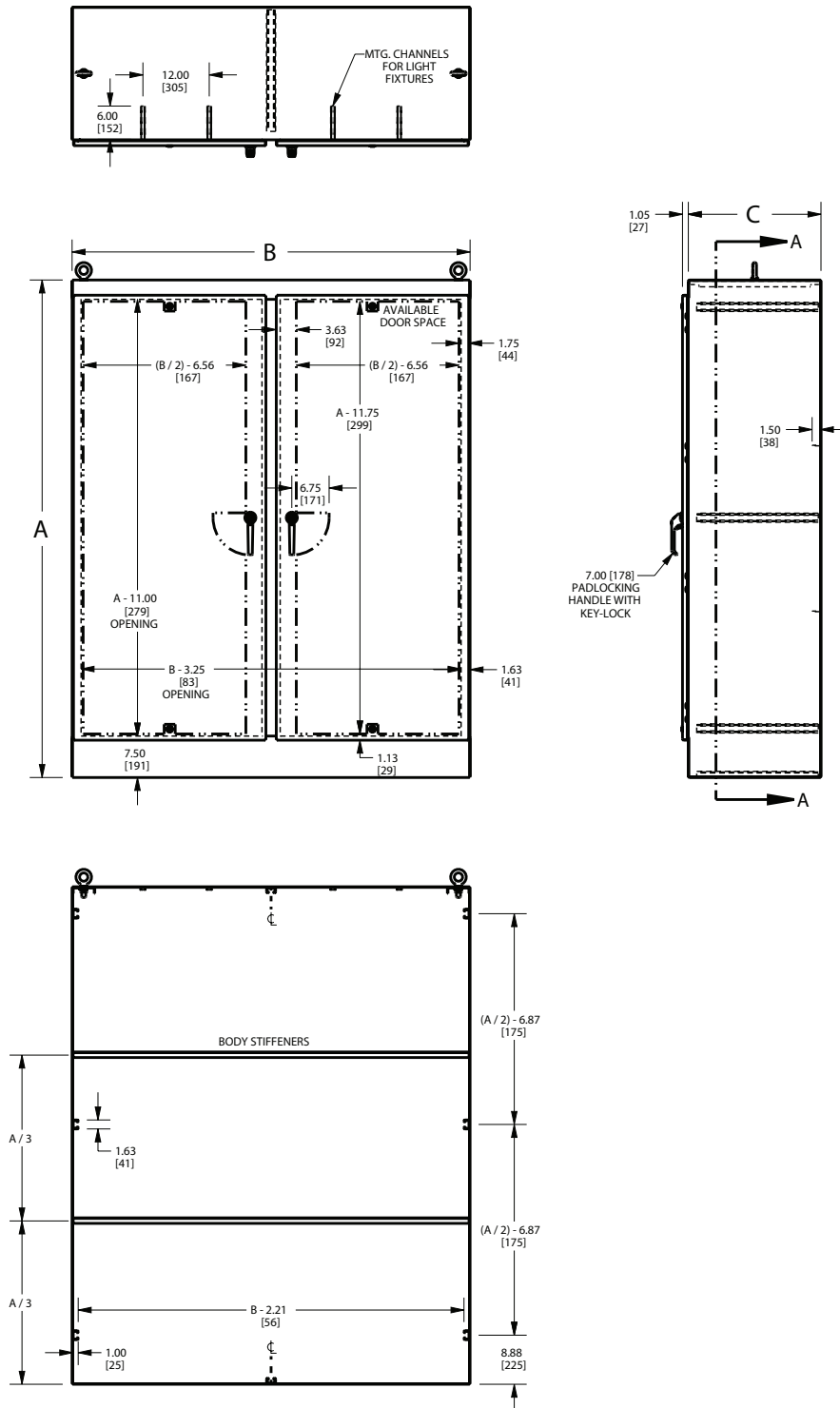

SECTION A-A



Phone (989) 799-6871
Fax (989) 799-4524