

DOOR HARDWARE

Quick Release Clamp Assembly

Designed for quick access to an enclosure with standard screw clamps. Clamps can be used on Type 4, 4X, and 12 enclosures.

Catalog No.	Enclosure Type	Finish	Qty. Per Kit	Product Code	List Price
SCE-QR1	"CHNF"	Chrome	1	P2	9.94
SCE-QR1SS	"CHNF"	Stainless	1	P2	19.87
SCE-QR2	"LP"	Stainless	2	P2	22.97
SCE-QRLP	"LP"	Stainless	2	P2	12.87



SCE-QR1



SCE-QR2



SCE-QRLP

Replacement Clamps

Designed as replacement clamps for SCE enclosures.

Catalog No.	Enclosure Type	Finish	Qty. Per Kit	Product Code	List Price
SCE-DRL-6	"CHNF"	Chrome	1	P2	7.46
SCE-DRL-4K	"LP"	Stainless	2	P2	12.42
SCE-LPCLAMP	"LP"	Chrome	1	P2	17.38
SCE-LPCLAMPSS	"LP"	Stainless	1	P2	21.87



SCE-DRL-6



SCE-DRL-4K

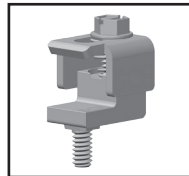

SCE-LPCLAMP/SS

Pull Handle

Designed for use as a handle on enclosures. Handle is a steel tube plastic coated black with black molded polyamide plastic end stays.

Catalog No.	Qty. Per Kit	Size	Product Code	List Price
SCE-UHK13	1	3.15 x 13.00	P2	39.74



Finger Pull

Designed for use as pull latch for the removable wireway.

Catalog No.	Description	Qty. Per Kit	Product Code	List Price
SCE-ELFP	Aluminum	1	P2	9.94

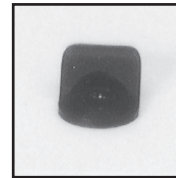

Padlock Kit For Junction Boxes

Designed for "CHNF" enclosures. Maintains water-tight and dust-tight seal. Made of plated steel.

Catalog No.	Qty. Per Kit	Product Code	List Price
SCE-PLKJIC	1	P2	9.94



Pull Handles - 4"

Designed for use on keyboard drawers, swing out panels, etc. Mounting hardware is included.

Catalog No.	Finish	Hole Center	Qty. Per Kit	Product Code	List Price
SCE-APH	Aluminum	4.00	1	P2	7.46



SCE-APH